

Master Specialties Company

Series 10E Twist-Lite® Pushbutton Switch

...for
rugged
duty!

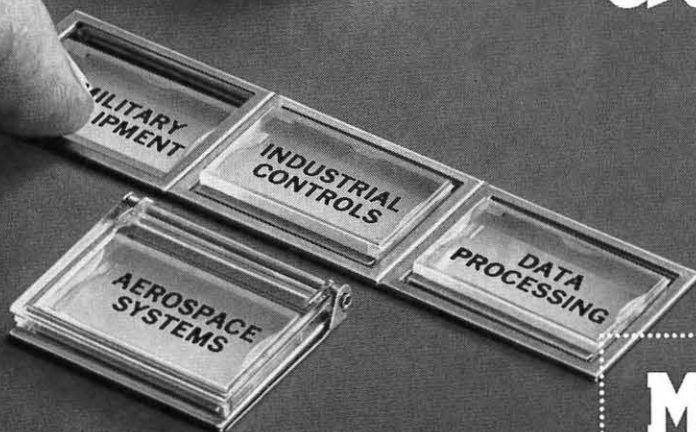
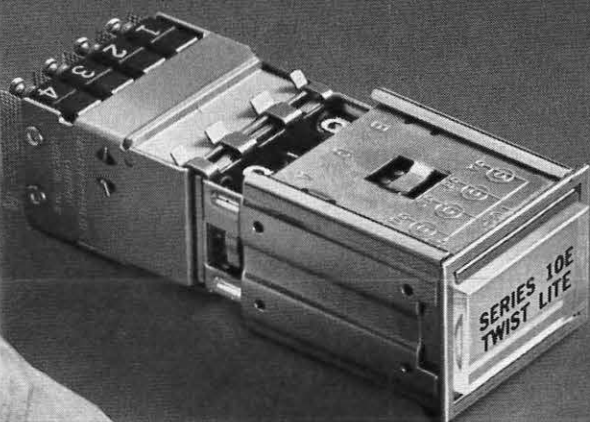

MSC



FULL SWITCHING AND INFORMATION DISPLAY CAPABILITY . . . RUGGEDIZED FOR RELIABILITY!

Mechanically, electrically and functionally engineered for rugged duty, Series 10E Twist-Lite Switches have been proven in military and aerospace applications . . . are now available for exacting industrial and commercial application.

Modular in construction, Series 10E units offer a host of standard and optional features that can be ordered under a single coded part number . . . including legends, reverse engraved to avoid wear.

Basic features include:

4-LAMP OPERATION for projected color, changeable lamp filters, display configurations ranging from full, horizontal, vertical, and three or four way split display to two color indication in full or split display.

INTERNALLY BUSSED LAMP CIRCUITS to simplify installation . . . reduce soldering operations.

SNAP-ACTION REMOVABLE SWITCH ASSEMBLIES in 2PDT or 4PDT contact arrangements, momentary or alternate action. Holding coil units for various interlock circuits are also standard.

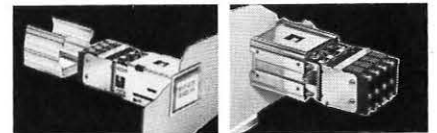

SIMPLE MOUNTING SLEEVE YIELDS A POSITIVE HARD MOUNT WITHOUT BRACKETS OR SPECIAL HARDWARE

Simply by turning captive screws in the housing, the mounting sleeve is drawn tight to a panel, providing a bearing surface along three sides of the panel cutout. Units mount in intimate contact in rows, stacks or matrices.

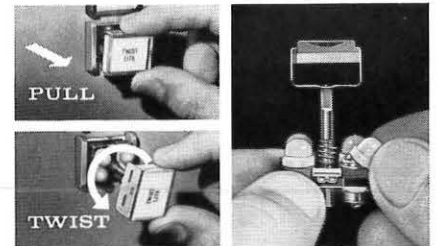

EASY TO RELAMP OR MODIFY FROM THE PANEL FRONT WITHOUT TOOLS OF ANY KIND!

A simple pull and twist removes the lamp/legend assembly from the housing to provide access to lamps, filters and legends . . . and it can be done without fear of accidental switching.

OPTIONAL FEATURES include: Switch Guard to prevent accidental switching; RFI Screens to minimize RFI passage through panel cutouts; Drip-Proof Seals to block the entrance of moisture, dust or liquids through panel cutouts, and; "Master Test" Control Capsules for lamp verification tests.

Full details are contained in
CATALOG 2000

*For specifications on Series 10H Military versions per Mil-S-22885, request Catalog 2022.

**MASTER
SPECIALTIES
COMPANY**

1640 MONROVIA, COSTA MESA, CALIFORNIA
TELEPHONE AREA CODE 714: 642-2427

REGIONAL OFFICES AND TELEPHONE

ALABAMA: Huntsville	205-536-7415
CALIFORNIA: Costa Mesa	714-642-0114
CALIFORNIA: Sunnyvale	408-245-9292
FLORIDA: Winter Park	305-647-0100
ILLINOIS: Chicago	312-282-7112
NEW YORK: Syracuse	315-479-9191
NEW YORK: Valley Stream, L.I.	516-561-2334
TEXAS: Dallas	214-357-9459